

In-The-Hoop Christmas Ornaments

Dress up your tree this Christmas with these adorable ornaments or attach one to a special gift for your friends and family.

Skill Level: Beginner

Created by: Christian Staum, Software QA

Required Software:

ADC-97J - In-The-Hoop Christmas Ornaments

Design used for these instructions: ORN117

(Choose any of the ornaments in the collection to start)

Supplies:

- Embroidery/Sewing Machine with a 5" by 7" hoop or larger
- Assorted embroidery threads and machine embroidery bobbin thread
- All Purpose sewing thread
- Tear-Away backing
- Tape
- Felt fabric
- Scissors
- General sewing supplies
- Ribbon

Read through all instructions before beginning.

INSTRUCTIONS:

Step 1:

Hoop one piece of felt fabric with tear away backing large enough to fit your hoop size. Sew the buttonhole design that corresponds to the ornament you want to create using thread that matches the color of felt you are using. Once finished, remove the fabric from the hoop, remove the tear away backing, and set aside.

Note: to make the buttonhole and tackdown stitch more visible we've used black instead of white thread.

Step 2:

Hoop a second piece of felt fabric with tear away backing large enough to fit your hoop size, and your selected ornament. Start stitching your selected design but stop your machine before the last color of the design. The last color is the tackdown stitch that will sew the two pieces of fabric together.

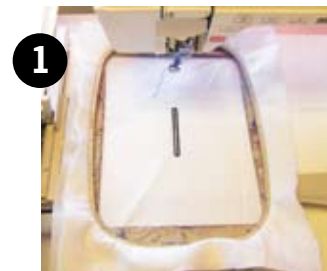

Continued on back page

Step 3:

Cut a 3-4" piece of ribbon, fold in half, and tape to the design with the open end of the ribbon facing away from the design. The ribbon should be placed on the top of the design and centered in the middle. This will function as a hanger for the ornament once it is finished.



Step 4:

Place the piece of fabric with the buttonhole on top of the ornament design and smooth flat. The finished side of the buttonhole should face inward. Place the buttonhole centered on top of the design as best you can. Placement does not have to be precise but it should generally be in the middle of the ornament.



Note: for designs ORN105 and ORN113 the buttonhole should be centered only on the torso of the design.

Step 5:

Sew the last color of the Christmas Ornament. This is the tackdown stitch that sews the two pieces of fabric together. Once finished, remove the fabric from the hoop and remove as much of the tear away backing as you can. This will make it easier to turn the ornament inside out.



Step 6:

Cut the felt fabric away from the outline stitch leaving about 1/4" from the seam. Wedges can be cut into the fabric for areas that have sharp angles on the seam which will give the ornament better definition once turned inside out (Image 6a). Pull the two pieces of fabric slightly apart before cutting the center of the buttonhole to avoid cutting the ribbon which is inside the fabric.



Turn the ornament inside out through the buttonhole. It is normally easier to turn the largest and most accessible areas inside out first before continuing to the more narrow areas. A pair of tweezers or the eraser end of a pencil can be used to help point out any areas with corners.

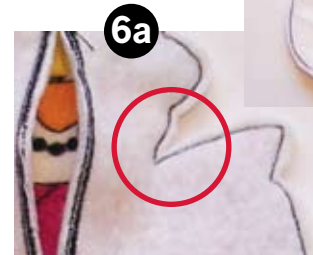

Step 7:

Stuff the ornament with fiberfill and sew the buttonhole closed with a needle and thread.



When finished your ornament should look like this:



Have fun creating your ornaments!

For other exciting projects like this one visit our site at www.AmazingDesigns.com